

**Aluminum Conduit Bodies Applications**

- For use on threaded rigid/IMC conduit
- Use conduit bodies for making turns in conduit systems, connecting conduit sections, as pull outlets, and to provide openings for maintenance and making taps and splices to conductors

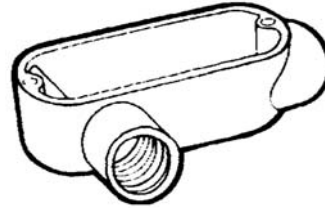

TYPE LR

**Aluminum Conduit Bodies Product Features**

- Flat back design for easy mounting close to walls
- Cast of high strength, corrosion and weather resistant aluminum alloy with painted finish
- May be used on aluminum or steel conduit
- Lightweight, makes installation simple

**Compliances**

- - Standard 514B
- - C22.2 #18

**ORDERING INFORMATION - DIMENSIONS**

TYPE LR				
CATALOG NUMBER	TRADE SIZE	UNIT CTN. QTY.	SHIP CTN. QTY.	UPC BAR CODE
EALR-1	1/2"	10	100	—
EALR-2	3/4"	10	50	—
EALR-3	1"	6	24	—
EALR-4	1-1/4"	2	8	—
EALR-5	1-1/2"	2	8	—
EALR-6	2"	1	5	—
EALR-7	2-1/2"	—	1	—
EALR-8	3"	—	1	—
EALR-9	3-1/2"	—	1	—
EALR-10	4"	—	1	—

TYPE LR

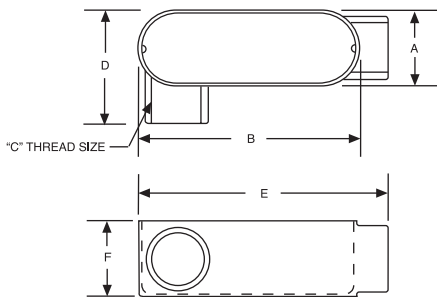

DIMENSIONS						
CONDUIT SIZE	A	B	C	D	E	F
1/2"	1-5/16"	3-7/8"	1/2"	2-3/64"	4-3/8"	1-7/16"
3/4"	1-1/2"	4-5/8"	3/4"	2-5/16"	5-1/8"	1-11/16"
1"	1-3/4"	5-3/8"	1"	2-21/32"	5-15/16"	1-15/16"
1-1/4"	2-1/2"	6-5/8"	1-1/4"	3-15/32"	6-7/8"	2-7/8"
1-1/2"	2-1/2"	6-5/8"	1-1/2"	3-15/32"	6-7/8"	2-7/8"
2"	3-1/8"	8-1/2"	2"	3-7/8"	9-7/32"	3-7/16"
2-1/2"	4-9/16"	12-1/4"	2-1/2"	6"	13-1/8"	4"
3"	4-9/16"	12-1/4"	3"	6"	13-1/8"	4-3/4"
3-1/2"	5-7/16"	14-7/8"	3-1/2"	6-1/4"	15-3/8"	5-1/2"
4"	5-7/16"	14-7/8"	4"	6-1/4"	15-3/8"	5-1/2"